

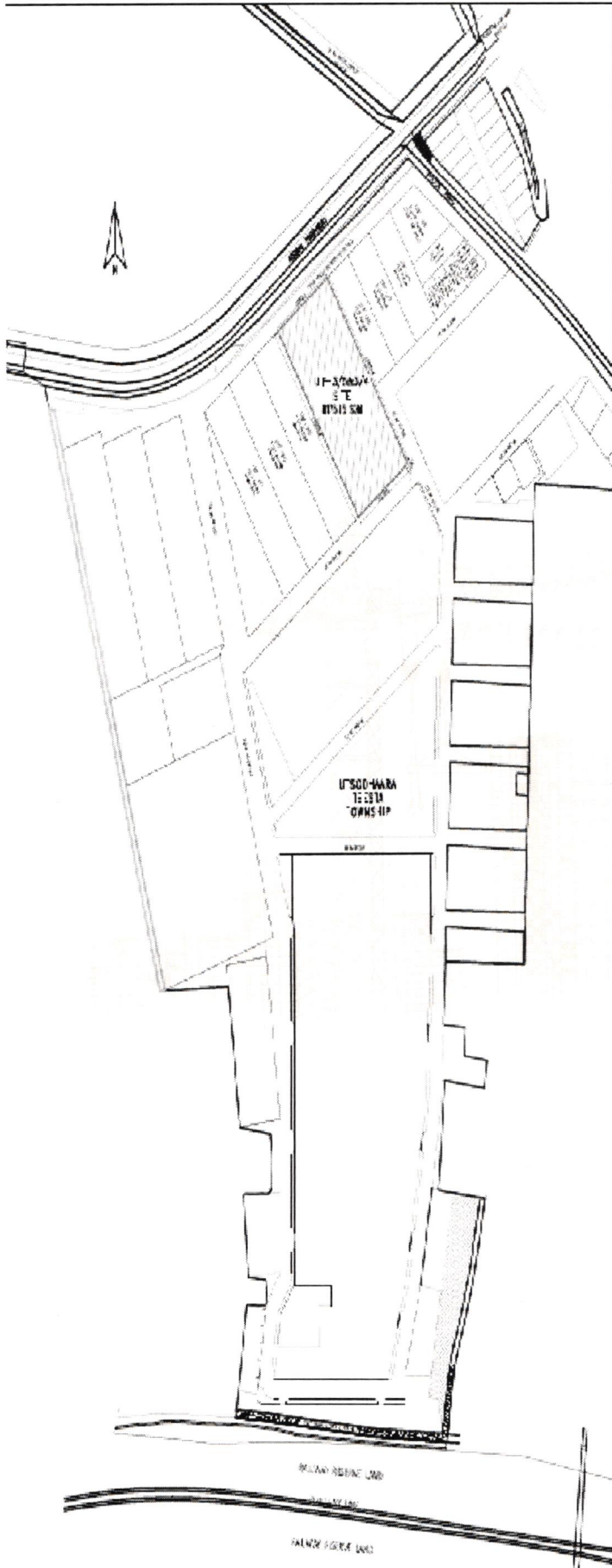

## SITE PLAN



- **PROJECT NAME-** TOWN HALL,
- **ADDRESS-** Scheme No- UIF 3/4 & UIF 3/5, Utsodhaara Teesta Township, Kawakhali, P.O.- Satellite Township, P.S.- Njp, Dist- Jalpaiguri, Pin- 734015, W.B,India
- **OWNER-** Urban Shapers LLP (Suman Mfg. Works Ltd. & Hillview Leisure Pvt. Ltd.)
- **SCHEDULE OF LAND-** Plot no- 23 (P), 34 (P), 35 (P), 36 (P), 37 (P), 38 (P), 39 (P), (L.R.), LR Khatian No- 13 & 12, Mouza- Dabgram Sheet No-192, J.L. No- 02, Dist- Jalpaiguri, W.B
- LATITUDE= 26.684985 N;
- LONGITUDE= 88.404279 E;

(Latitude & Longitude has been measure near the centre of this plot)

**Urban Shapers LLP**

*Prashant Kumar Shoy*

**Authorised Signatory**

SITE CO-ORDINATES: 26°4'00" N 88°24'15" E

Regd. Office 6 Lyons Range, Unit No. 2, 5th Floor, Kolkata, 700001 (W.B)

Operation Address 3rd Floor, Orchid Square, S.F Road, Siliguri, 734005 (W.B)

E urbanshapers@embeebuilders.com | CIN ACD-3323 | T +91 353 250 1615 / 1616